

LOC		DIST		P		F		ZONE		LTR		REVISIONS			
AD	25											DESCRIPTION	DATE	APPD	
												J	REV PER EC 0512-0016-03	11DEC03	AS

- ② MATERIAL: GLASS-FILLED POLYESTER. COLOR: GRAY.
- ③ AMP PART NUMBER MOLDED IN THIS APPROXIMATE AREA.
- ④ INTERFERENCE CAVITIES LOCATED AT POSITIONS 1,32 IN ROWS "A" AND "C".

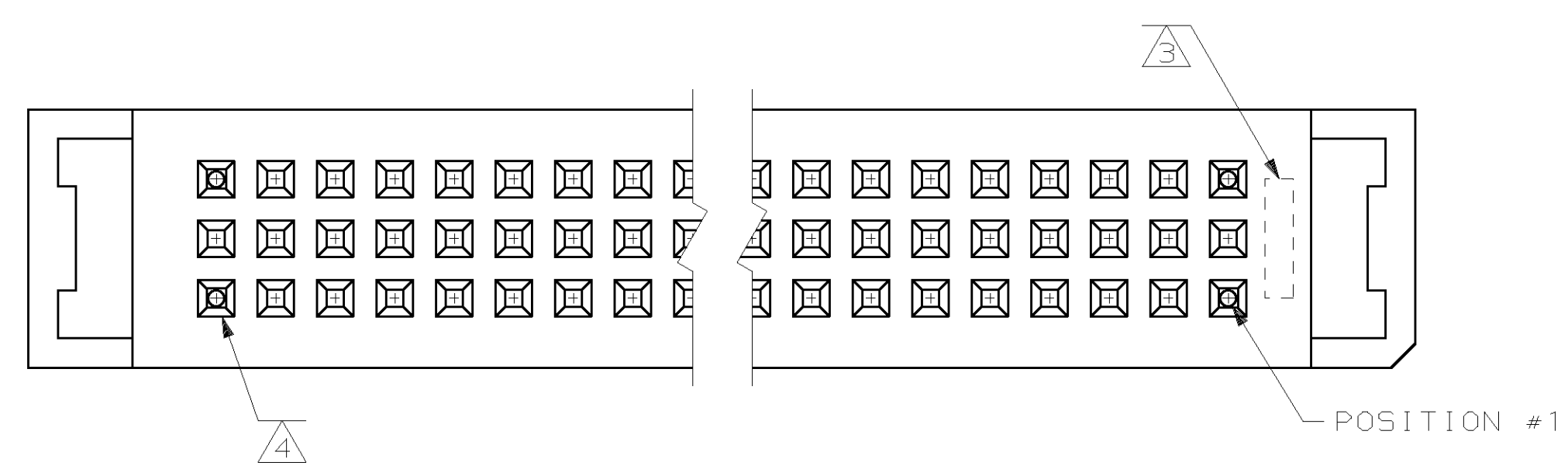
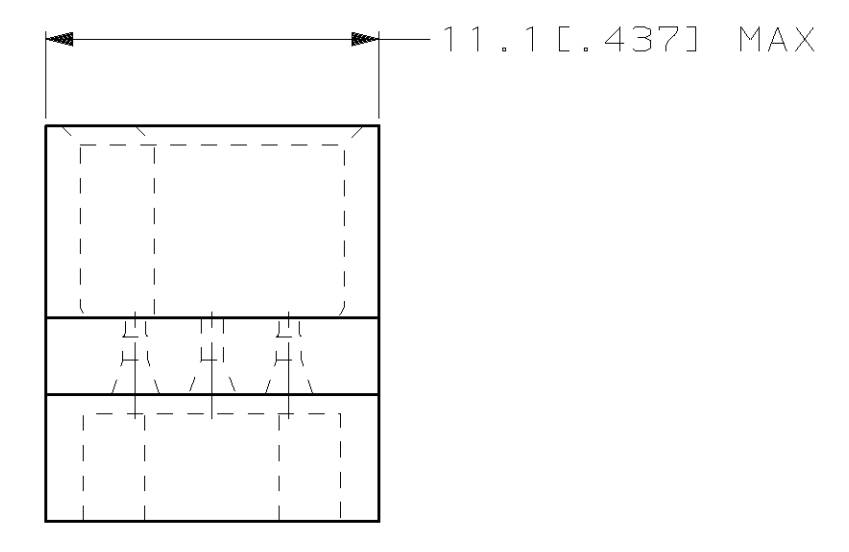
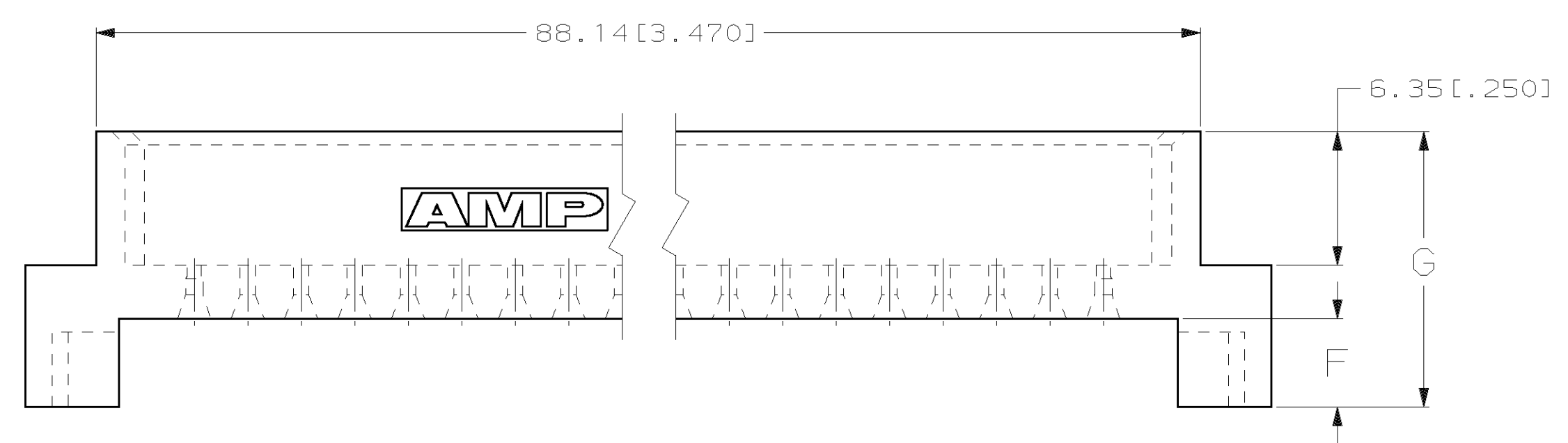
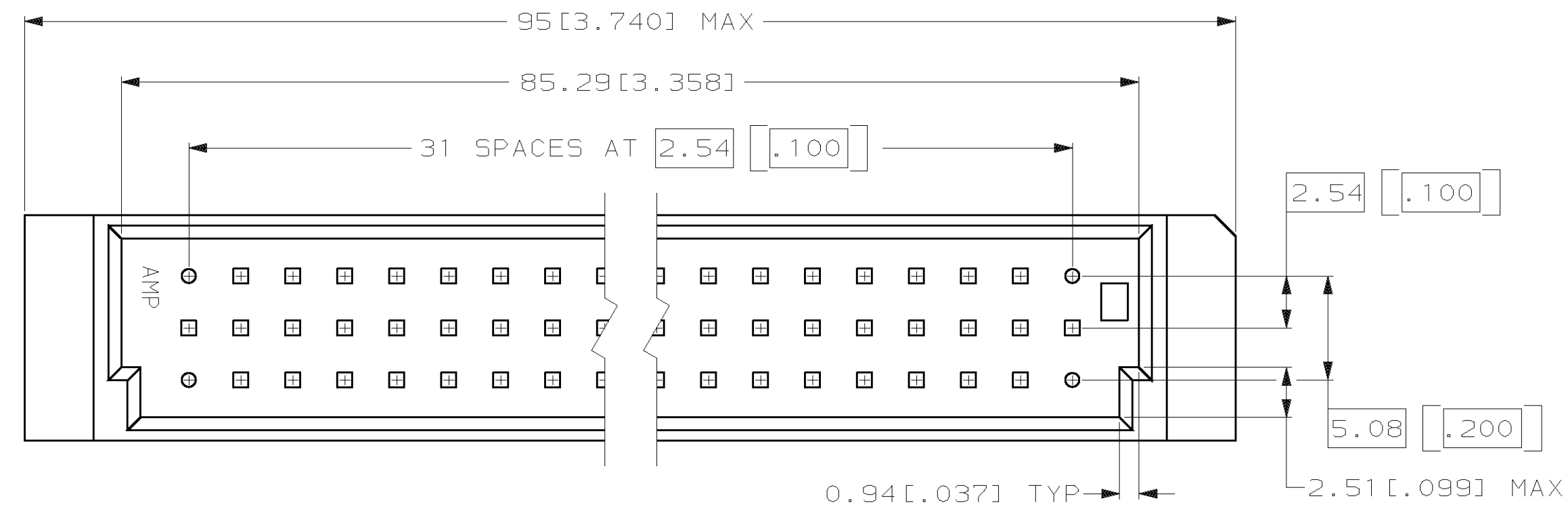

OBSOLETE	17 [0.669]	3.94 [0.155]	14.48 [0.570]	5.59 [0.220]	1-533236-4
OBSOLETE	-	-	8.89 [0.350]	-	1-533236-3
OBSOLETE	18.62 [0.733]	1.57 [0.062]	18.42 [0.725]	9.53 [0.375]	1-533236-2
	17 [0.669]	1.57 [0.062]	16.89 [0.665]	8.00 [0.315]	1-533236-1
	13.23 [0.521]	1.57 [0.062]	13.08 [0.515]	4.19 [0.165]	1-533236-0
OBSOLETE	18.62 [0.733]	2.36 [0.093]	17.78 [0.700]	8.89 [0.350]	533236-9
	17 [0.669]	2.36 [0.093]	16.13 [0.635]	7.24 [0.285]	533236-8
	13.23 [0.521]	2.36 [0.093]	12.32 [0.485]	3.43 [0.135]	533236-7
SUPERSEDED BY 1-533236-1	18.62 [0.733]	3.18 [0.125]	16.89 [0.665]	8.00 [0.315]	533236-6
	17 [0.669]	3.18 [0.125]	15.24 [0.600]	6.35 [0.250]	533236-5
	13.23 [0.521]	3.18 [0.125]	11.43 [0.450]	2.54 [0.100]	533236-4
OBSOLETE	-	-	17.27 [0.680]	8.38 [0.330]	533236-3
OBSOLETE	-	-	15.24 [0.600]	6.35 [0.250]	533236-2
OBSOLETE	-	-	11.43 [0.450]	2.54 [0.100]	533236-1
CONNECTOR TAIL LENGTH		PC BOARD THICKNESS	G	F	PART NUMBER

DO NOT SCALE PRINT. UNLESS SPECIFIED DIMENSIONS IN mm [INCHES]		DR		PART NO	
TOLERANCES ON:		L. BRINER	12/9/91	AMP Incorporated Harrisburg, PA 17105-3608	
1 PLC DEC ± -		R. PATTERSON	12/18/91		
2 PLC DEC ± 0.13 [0.005]		R. PATTERSON	12/18/91	NAME	
ANGLES ± -		K.R. PARMER	12/18/91	SHROUD, EUROCARD WITH STANDOFFS	
MATERIAL		PRODUCT SPEC		SIZE	
HSG: ② -		-		D	00779
FINISH		APPLICATION SPEC		DRAWING NO	
-		-		533236	
WEIGHT		SCALE		SHEET	
-		4:1		1 OF 1	

